

SE70-B-62 - SPEEDLINE System Data Sheet - Version V1 (24-10-23)

SPEEDLINE 70mm 'I' Stud Shaft Encasement
 @600mm Ctrs, with 2x BG Gyproc 15mm FireLine,
 BG Gyproc 19mm CoreBoard,

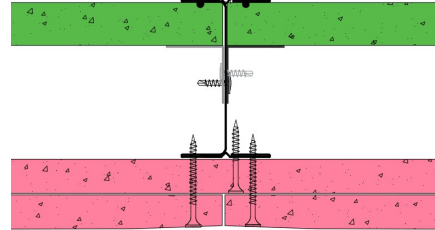

System Performance Breakdown

Fire Resistance:

BS476 Part 22:1987:
 (Integrity/Insulation).

Test Ref & Date or Applied Ref & Report:

Max Height:

Thickness:

Duty Grade: BS 5234: Part 2:1992:

Sound Insulation:

120/120 FromShaftSide, 90/90 FromLandingSide Minutes

BRE 302289 - BRE Report P102396-1012A

Refer to Speedline Specification Clause

102 mm. (At Base Track, Excluding Finishes)

Severe - Annexes A-F

41 R_wdB, Date Tested or Assessed Against -

TESTED AT ONE OF THE UKAS
 ACCREDITED LABORATORIES
 BELOW

B.T.C
 (H-Ref on Graph)



B.R.E



AIRO



S.R.L

